

LINED INSTRUMENT TEE

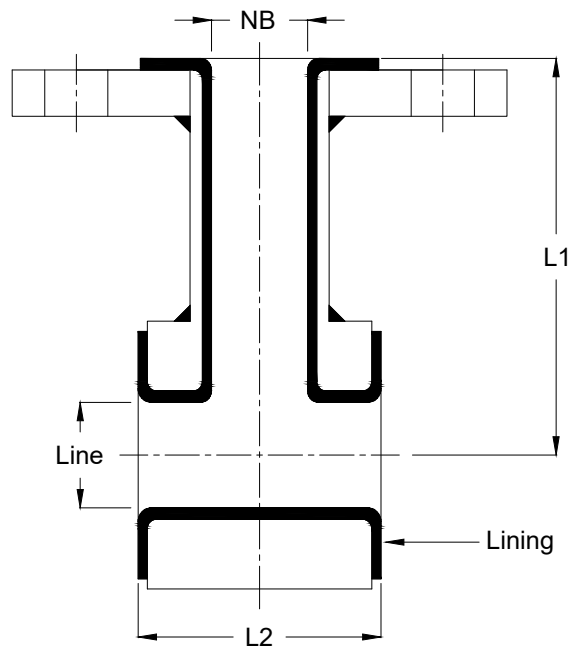

| Dimension Detail | | | | | |
|------------------|------|----|------|-----|----|
| Line | | NB | | L1 | L2 |
| MM | Inch | MM | Inch | MM | MM |
| 25 | 1" | 25 | 1" | 89 | 51 |
| 40 | 1½" | 25 | 1" | 102 | 51 |
| 40 | 1½" | 40 | 1½" | 102 | 76 |
| 50 | 2" | 25 | 1" | 114 | 51 |
| 50 | 2" | 40 | 1½" | 114 | 76 |
| 80 | 3" | 25 | 1" | 140 | 51 |
| 80 | 3" | 40 | 1½" | 140 | 76 |
| 100 | 4" | 25 | 1" | 165 | 51 |
| 100 | 4" | 40 | 1½" | 165 | 76 |
| 150 | 6" | 25 | 1" | 203 | 51 |
| 150 | 6" | 40 | 1½" | 203 | 76 |
| 200 | 8" | 25 | 1" | 229 | 51 |
| 200 | 8" | 40 | 1½" | 229 | 76 |
| 250 | 10" | 25 | 1" | 279 | 51 |
| 250 | 10" | 40 | 1½" | 279 | 76 |
| 300 | 12" | 25 | 1" | 305 | 51 |
| 300 | 12" | 40 | 1½" | 305 | 76 |

Specification:

Body: Steel Fabrication ASTM A106 Gr. B Sch. 40 pipe
Ductile Iron GGG40.3 / ASTM A395

Cast Steel ASTM A216 Gr. WCB

Flange: ANSI B16.5 / B16.42

Optional Drilling Standard on Request:

DIN 2632 / 2633 BS 10 Table D, E, F

Face To Face: ANSI B16.5 #150

Lining: FEP / PFA / HDPE / PP / PVDF

Lining Thickness: 3mm to 6mm

Inspection & Testing: ASTM F1545-97

Hydraulic Test: 25 Kg/Cm²

Spark Test: 15 Kv

